

Bevercotes Pit Wood

Scale 1:7500 Contour Interval 5m

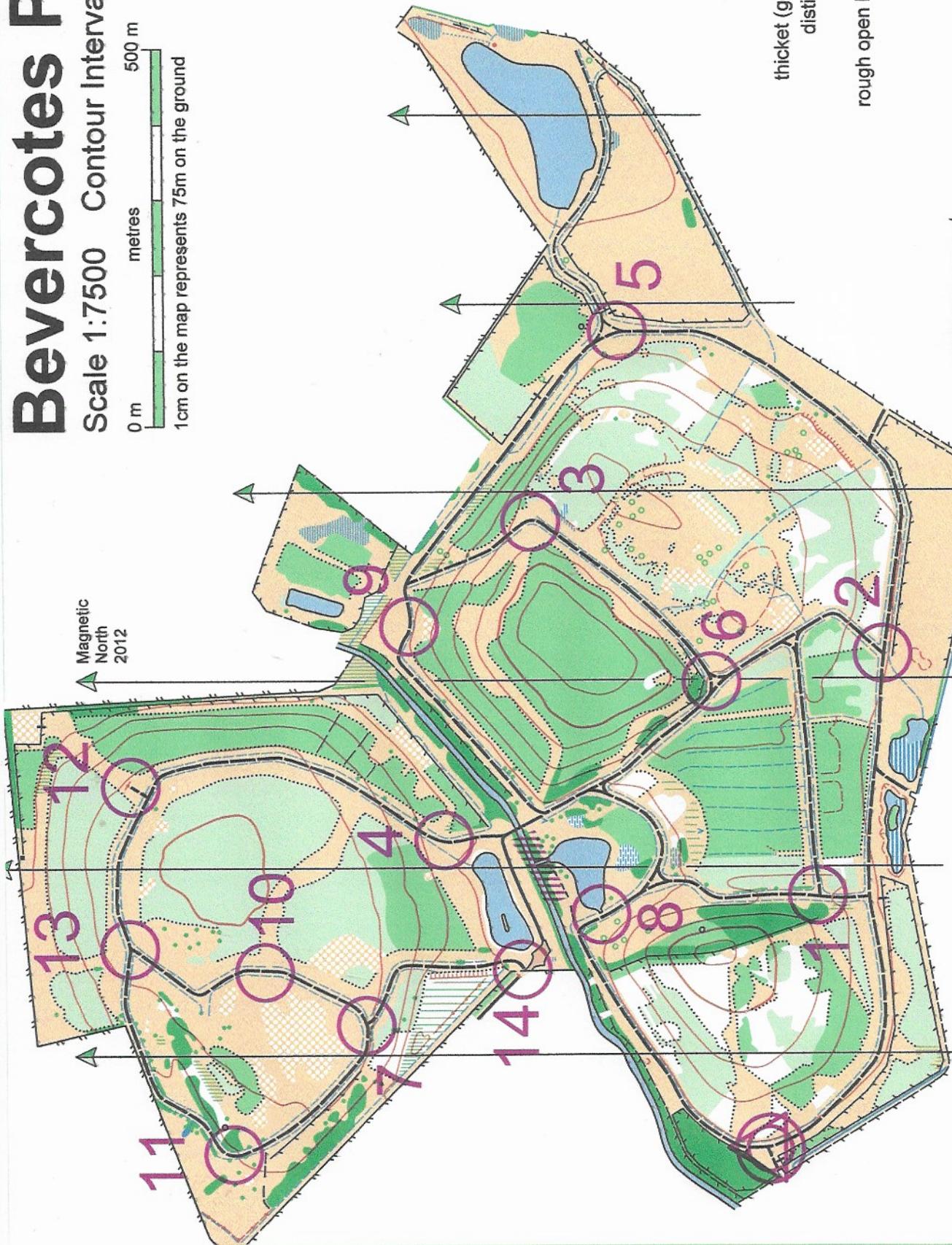

- road
- track
- path
- indistinct path
- narrow ride
- fence, stile
- ruined fence
- high fence
- hedge
- surfaced area
- bird box
- tripod
- contour
- index contour
- form line
- earth wall
- knoll: large, small
- gully, depression
- lake, pond
- wet pit
- river
- wide stream
- ditch
- uncrossable marsh
- marsh
- thicket (gorse bush), isolated tree
- distinct vegetation boundary
- rough open land
- rough open land with scattered trees
- forest: run
- forest: slow run
- forest: difficult to run
- vegetation: impassable
- forest: runnable in one direction
- undergrowth: slow run
- undergrowth: difficult to run



Magnetic North 2012

NOC
 Nottinghamshire Orienteering Club
 For further information about orienteering in Nottinghamshire visit www.noc-uk.org

Possession of this map does not imply right of access to the area for orienteering or any other purpose. Permission must be obtained from the landowner.

Based upon the Ordnance Survey mapping with the permission of the Controller of Her Majesty's Stationary Office. © Crown Copyright.
 Licence No. 100015287.
 Event Registration Number..... NOC-20-TRAINING
 Grid Reference SK703738
 Survey & Cartography R. Postlethwaite 2006
 Revised Peter Hubberstey 2010 & 2013
 Further Revisions Andrew Ridgway 2016, 2017, 2020
 Copyright